



Site Address: Bhairav Nagar, S.No. 319, Shirur- Golegaon Road, Shirur Pune - 412 210
Office: 30 A, Ramkrupa , Yashvant Colony, Shirur, Pune - 412 210

CHIEF PROMOTER
RAVINDRA RAMCHANDRA DHANAK M.Sc. Agri.
Mob: 92255 47739
E-mail: rrdhanak@gmail.com

CREDITS

ARCHITECT
K.C.ASSOCIATES
PUNE.

R.C.C. CONSULTANT
G.A BHILARE CONSULTANTS PVT. LTD.
PUNE.

LEGAL ADVISOR
ADV. K.B. WABLE
RTD. JOINT REGISTRAR OF
CO-OP. SOCIETIES

CHARTERED ACCOUNTANT
A.B. THORAT & COMPANY

PROJECT CO-ORDINATOR
SANJAY P. BANDE
90282 83417

ADV. DHIRAJ JADHAV
98508 11797

All the specification, design, facilities, dimensions, etc. are subject to the approval of the respective authorities & developers and would be changed if necessary. The discretion remains with the developers.
The pictures used in this promotional material are entirely the impression of an artist's imagination and must not be misconstrued as real examples

हे माहिती पत्रक फक्त सभासदांच्या माहितीसाठी प्रस्तावित केलेले आहे.
याचा जाहिरातीसाठी उपयोग करू नये.



BHAIRAV DHAN RESIDENCY

A Co Partnership Housing Society Project

Project Developed by



Elegance Tower



A future Landmark
of Golegaon Road, Shirur.

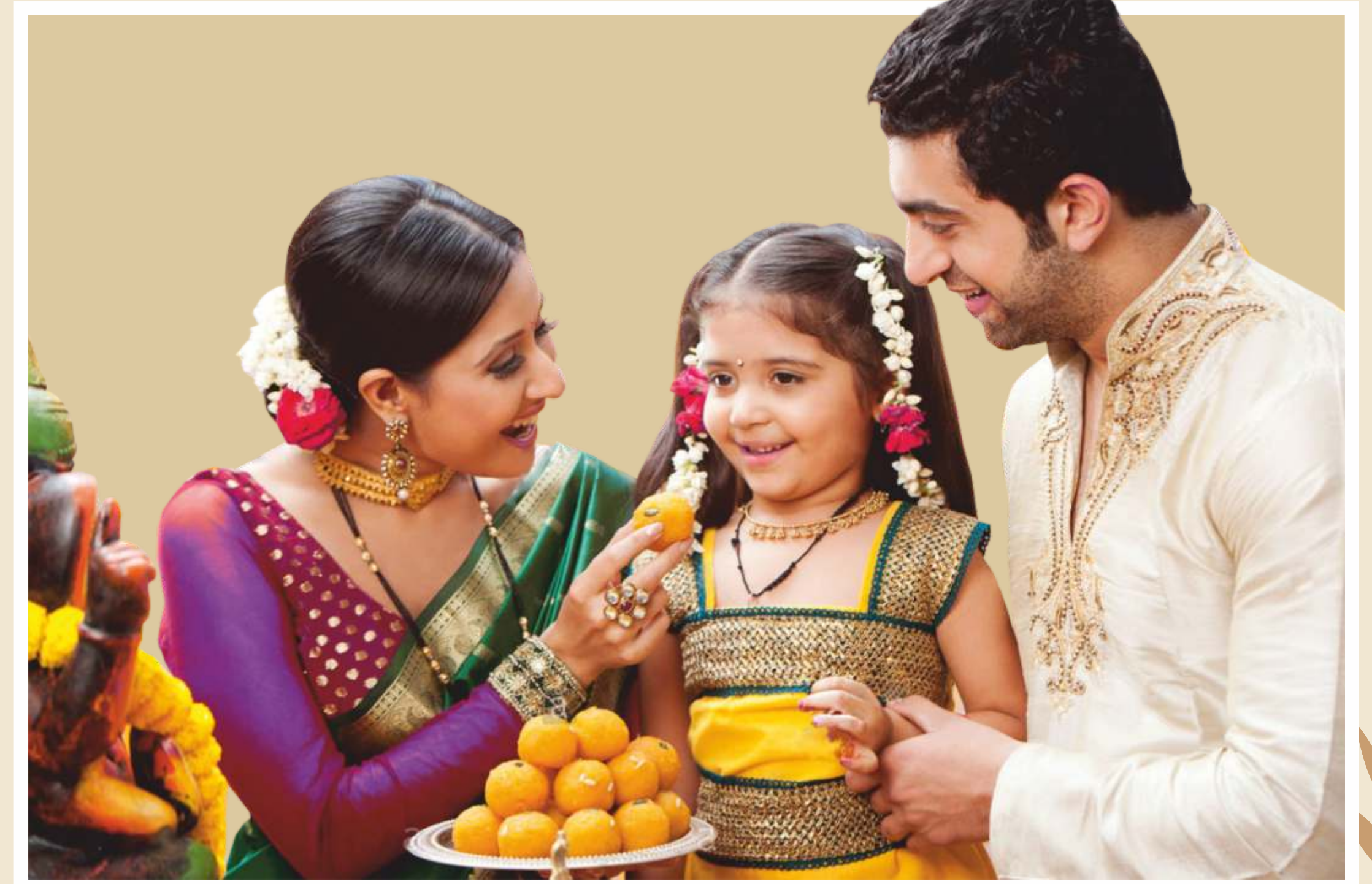



FLOOR PLAN - 1 BHK

CARPET AREA OF 1.5 BHK UNIT	TYPE A = 479 SQ.FT.
	TYPE B = 459 SQ.FT.

- 3 - 103, 203, 303, 403, 503, 603, 703
- 4 - 104, 204, 304, 404, 504, 604, 704
- 5 - 105, 205, 305, 405, 505, 605, 705
- 6 - 106, 206, 306, 406, 506, 606, 706

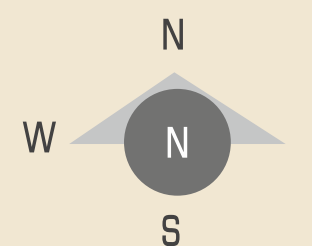
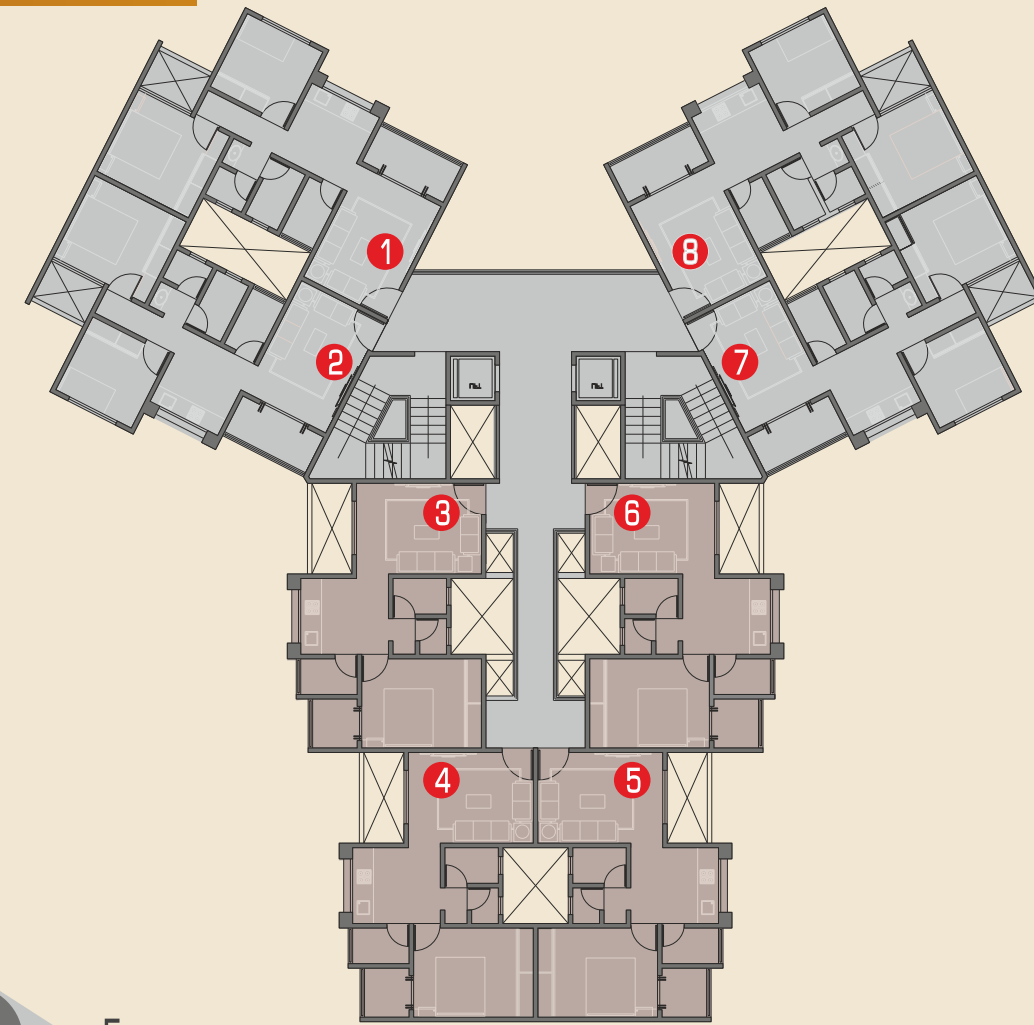

KEY FLOOR PLAN

CUT SECTION IMAGE - 1 BHK

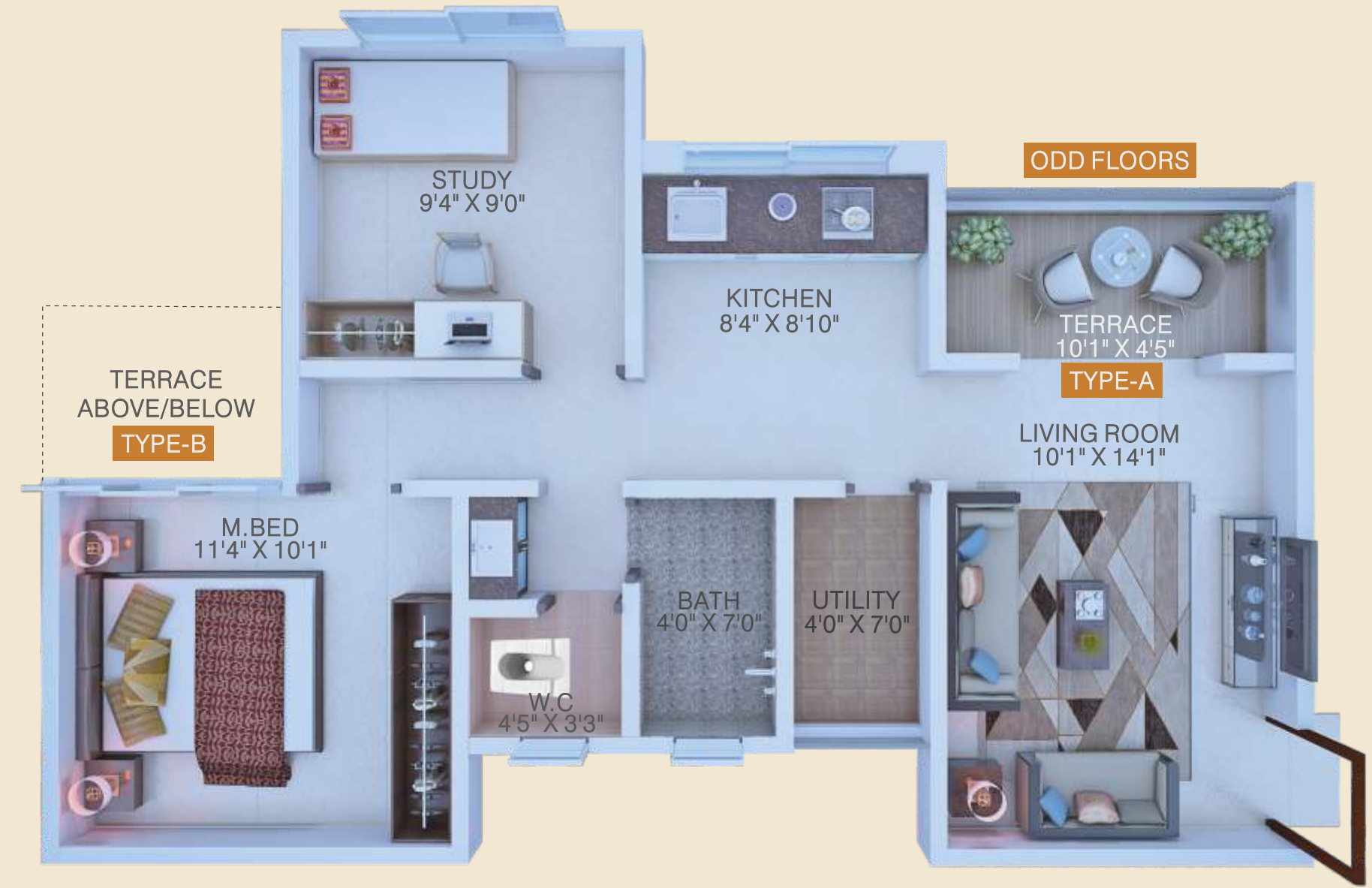

FLOOR PLAN - 1.5 BHK

CARPET AREA OF 1.5 BHK UNIT	TYPE A = 588 SQ.FT.
	TYPE B = 571 SQ.FT.

- 1 - 101,201,301,401,501,601,701
- 2 - 102,202,302,402,502,602,702
- 7 - 107,207,307,407,507,607,707
- 8 - 108,208,308,408,508,608,708

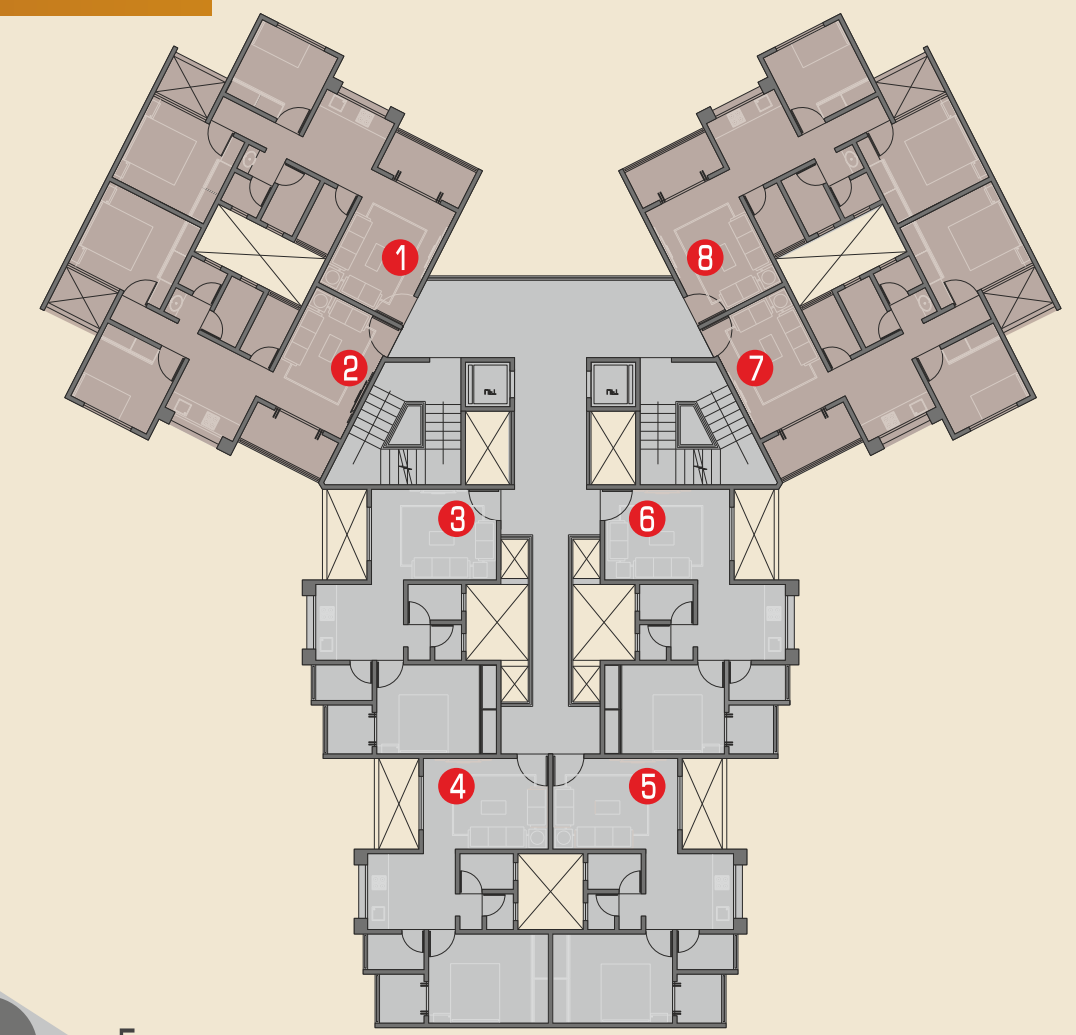

KEY FLOOR PLAN

CUT SECTION IMAGE - 1.5 BHK





Specifications

- ☀ **RCC**
 - ☀ Structure with earthquake resistance.
- ☀ **Brickwork**
 - ☀ 6 " thick external and internal Brickwalls.
- ☀ **Doors**
 - ☀ Designer main door with Branded security Lock.
 - ☀ Internal laminated doors.
- ☀ **Windows**
 - ☀ Aluminium Domal Series French Door & 3 Track sliding Windows with mosquito mesh.
 - ☀ Designer M.S safety grills for all windows.
 - ☀ Granite Cill for all the windows.
- ☀ **Flooring**
 - ☀ Italian Finish 600X600 mm Vitrified Tile for all rooms.
 - ☀ Antiskid flooring for washrooms and terrace.
 - ☀ Common Lift Lobby in Granite.
- ☀ **Wall Finishes and Painting**
 - ☀ All walls in gypsum finish.
 - ☀ Internal wall finish in Luster Paint.
 - ☀ External Premium Paint with Exterior Grade Water Resistant Primer.
- ☀ **Electric**
 - ☀ All Concealed electrification in Polycab /Finolex with Adequate electrical points.
 - ☀ Branded Modular switches.
- ☀ **Kitchen**
 - ☀ Kitchen Platform in Granite.
 - ☀ Stainless Steel Sink.
 - ☀ Provision of Water purifier in kitchen.
 - ☀ Common Wash basin Lobby.
 - ☀ Plumbing Provision for washing machine in Dry Balcony.
 - ☀ Provision of Exhaust fan in Kitchen Window.
 - ☀ Modular Kitchen Trolleys.
- ☀ **Toilet**
 - ☀ Decorative Tiles up to 8' height.
 - ☀ High quality CP fittings.

Brand We Use

- ☀ **Steel**
 - ☀ FE 500.
- ☀ **Bricks**
 - ☀ 6" Thk Good Quality Red Brick.
- ☀ **Tiles**
 - ☀ Imported Premium Quality.
- ☀ **Main Door**
 - ☀ Customised Designer main doors with Frame.
- ☀ **Internal Door**
 - ☀ Laminated doors with Box frame and fittings.
- ☀ **Locks**
 - ☀ Godrej Lock For Main Door.
 - ☀ Mortise Locks for Internal.
- ☀ **UPVC Windows**
 - ☀ NCL Wintech or Equivalent.
- ☀ **Paints**
 - ☀ Asian Paints.
- ☀ **Switches**
 - ☀ Legrand Modular Switches.
- ☀ **Wires**
 - ☀ Polycab/Finolex.
- ☀ **ELEVATORS**
 - ☀ KONE/SHINDLER.
 - ☀ Designer High Speed Elevators with Auto Doors.
- ☀ **Generator**
 - ☀ Kirloskar.
- ☀ **Plumbing**
 - ☀ Astral CPVC/UPVC Pipes.
- ☀ **Sanitary & Plumbing Fitting**
 - ☀ All Sanitary Fittings of Jaguar Make.
- ☀ **Stainless Steel Sink**
 - ☀ Anupam.
- ☀ **Glass**
 - ☀ Modiguard.
- ☀ **Branded Sanitary ware**
 - ☀ Provision of Exhaust fans in every Toilet.
 - ☀ Hot Water through Solar in Common Toilet.
- ☀ **Parking**
 - ☀ Ample Private Covered Car Parking Space.
 - ☀ Ample Space for Common Car Parking.
- ☀ **Terrace**
 - ☀ Each apartment has Exclusive Exterior Finish Terrace.
 - ☀ SS Railings for Terrace.
- ☀ **Comforts**
 - ☀ 06 Persons Elevator with ARD Enabled for Safety.
 - ☀ Power backup For Common Areas.
 - ☀ Common Solar System for Hot Water.
 - ☀ Designer Benches for Senior Citizen.
 - ☀ Provision of Inverter Backup in each Apartment.



Amenities

Parking

- Dedicated Covered Car Parking Space and Common 2 Wheeler Parking.

Entrance

- Internal Open area with PAVED Tile.

Leisure

- Adequate Senior citizen relaxing area.
- Greenary around Periphery of Boundary Wall.

Terrace

- Each apartment has good and Exclusive Terrace.
- SS Railings for Terrace.

Comforts and Security :

- 02 Dedicated Lifts with 06 Persons Capacity with Generator back up.
- 02 Staircases For Easy Exit in case of Fire.
- Generator back up for all Essential Common Areas.
- All Common areas Under CCTV Surveillance including inside Elevators.
- Rain water harvesting.
- Common Solar System for Hot Water in Toilets.
- Provision of Inverter Backup in each Apartment.
- Providing Common DTH Services for Set up Box for Every Apartment.

Location Map

